



Unitek™ Gemini SL Self-Ligating Brackets

MBT™ Versatile+ Appliance System

MBT™
Versatile+ Appliance System

Efficient Self-Ligating Performance

Unitek™ Gemini SL Self-Ligating Brackets offer the simplicity of a door self-ligating appliance with the advantages of 3M quality and expertise in orthodontic bracket design. An advanced Nitinol ligating mechanism provides low resistance to door opening and closing, without using special techniques or instruments.¹ Nitinol also offers the advantage of high resistance to unwanted mechanism fatigue,² which can affect door operation and bracket performance during treatment.

Passive self-ligating Unitek Gemini SL brackets feature reduced friction for treatment efficiency,³ but you can also utilize the benefits of tie-wings, which permit active control with ligatures when you need it.⁴ The bracket's smooth finish and rounded profile offer patient comfort, and while choosing the MBT™ Appliance System offers predictable treatment results for a complete spectrum of treatment requirements. Discover the advantages of Unitek Gemini SL brackets for your practice.

Features

- Passive self-ligating U/L 5x5 bracket system
- Secure Nitinol ligating mechanism
 - low resistance to open/close operations
 - high resistance to fatigue
 - lock feature to prevent unintended opening
- Tie-wings for ligation when needed
- 80 gauge mesh base to increase bond retention⁵
- Rhomboid design for efficient bracket positioning⁶
- Compound-curvature base for optimal bracket placement⁷
- Smooth rounded finish for patient comfort⁸

Rounded Corners for improved patient comfort. The corners and ligating mechanism feature the same buccal curvature as the bracket body.

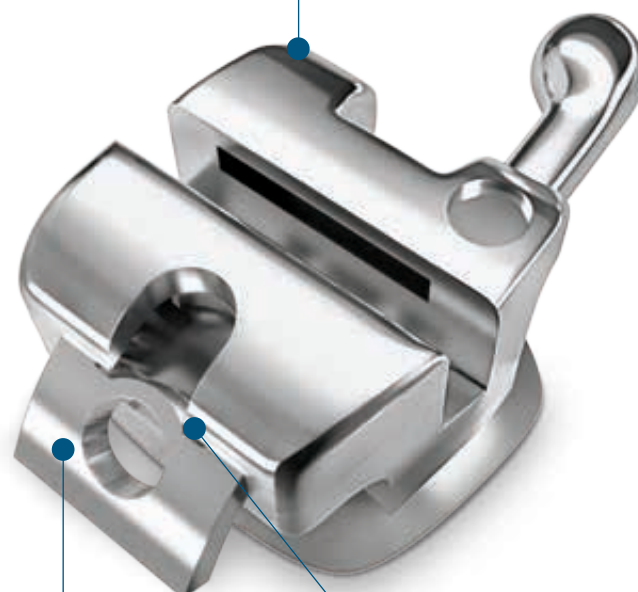

Nitinol Ligating Mechanism features elasticity and high resistance to fatigue during treatment.

Locking Mechanism is designed to prevent inadvertent door opening during treatment.

For more information, contact your
3M Unitek representative today!

80 Gauge Mesh Base
for better adhesive coverage to increase bonding retention.

Compound Curvature Base
allows for a better bracket fit to tooth anatomy and easier bracket positioning.

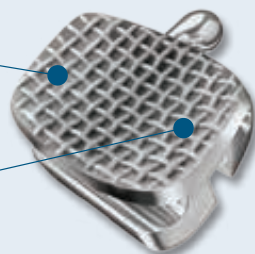

3M Unitek

Unitek™ Gemini SL Self-Ligating Brackets



MBT™
Versatile+ Appliance System

Unitek™ Gemini SL Brackets – MBT™ Appliance System

Maxillary			IN/OUT		Part Number – .022 in.	
Tooth	Torque	Angulation	in.	mm	L	R
Central	+17	4	.039	1.00	027-300	027-301
Lateral	+10	8	.043	1.10	027-302	027-303
Cuspid	-7	8	.029	0.73	027-304	027-305
Cuspid HK	0	8	.029	0.73	027-306	027-307
Bicuspid	-7	0	.034	0.86	027-308	
Bicuspid HK	-7	0	.034	0.86	027-309	027-310

Mandibular			IN/OUT		Part Number – .022 in.	
Tooth	Torque	Angulation	in.	mm	L	R
Anterior	-6	0	.047	1.20	027-371	
Cuspid	-6	3	.022	0.57	027-372	027-373
Cuspid HK	0	3	.022	0.57	027-374	027-375
1st Bicuspid	-12	2	.030	0.76	027-376	027-377
1st Bicuspid HK	-12	2	.030	0.76	027-378	027-379
2nd Bicuspid	-17	2	.034	0.86	027-380	027-381
2nd Bicuspid HK	-17	2	.034	0.86	027-382	027-383

Single Patient Kits

Single Patient Kit	Part Number – .022 in.
U/L 5x5 Hooks	027-110

Unitek™ Gemini SL Self-Ligating Bracket Profile

Features	Advantages	Benefits
Passive bracket	Closing mechanism does not touch archwires	Reduced friction
Door design with low resistance to opening and closing	Efficient ligation with smooth opening	Ligating mechanism does not open spontaneously. Very low force is needed to open mechanism
Nitinol ligating mechanism	High resistance to fatigue during the opening and closing of ligating mechanism	Maintains product integrity during treatment
Lock on the ligating mechanism	Secure ligation	Consistent forces
Bracket design allows for ligation	Bracket can be active or passive depending on treatment needs	Treatment versatility
Rounded corners	No sharp edges	Patient comfort
Rhomboidal shape	Better reference for bracket positioning	Efficient bracket positioning
80 gauge mesh base	Large area for adhesive placement	Enhanced bond strength



**3M Unitek
Orthodontic Products**
2724 South Peck Road
Monrovia, CA 91016 USA
www.3MUnitek.com

MBT and Unitek are trademarks of 3M.
© 2013, 3M. All rights reserved.
021-149 1311

References

- 3M Unitek Claims DB, "Unitek™ Gemini SL Self-Ligating Bracket's sliding door design opens and closes effectively with low forces", S10545, 05/2011
- 3M Unitek Claims DB, "Unitek™ Gemini SL Self-Ligating Bracket's sliding door is made of Nitinol, a material with high resistance to fatigue", S10538, 06/2011
- 3M Unitek Claims DB, "Unitek™ Gemini SL Self-Ligating Bracket's passive design promotes low friction", S10537, 05/2011
- 3M Unitek Claims DB, "Unitek™ Gemini SL Self-Ligating Bracket's versatile design allows the addition of ligatures for active ligation as needed during treatment", S10543, 06/2011
- 3M Unitek Claims DB, "The Unitek™ Gemini SL Self-Ligating Bracket has an 80 gauge mesh base that provides more space for the adhesive, to increase bonding retention", S10694, 10/2013
- 3M Unitek Claims DB, "Unitek™ Gemini SL Self-Ligating Bracket's rhomboid-shaped bracket body enables a more efficient bracket placement", S10544, 06/2011
- 3M Unitek Claims DB, "Unitek™ Gemini SL Self-Ligating Bracket bases have compound curvatures, allowing for better bracket placement", S10548, 06/2011
- 3M Unitek Claims DB, "Unitek™ Gemini SL Self-Ligating Bracket is designed with rounded corners for improved patient comfort", S10542, 06/2011

Unitek™ Gemini SL Brackets are sold under license using technology created by Dr. Luis Carriere.